

IDLE SPEED INSPECTION

EM1X3-02

1. INITIAL CONDITIONS

- (a) Engine at normal operating temperature
- (b) Air cleaner installed
- (c) All pipes and hoses of air induction system connected
- (d) All accessories switched OFF
- (e) All vacuum lines properly connected
- (f) SFI system wiring connectors fully plugged
- (g) iCorrect ignition timing
- (h) Transmission in neutral
- (i) Air conditioning switched OFF

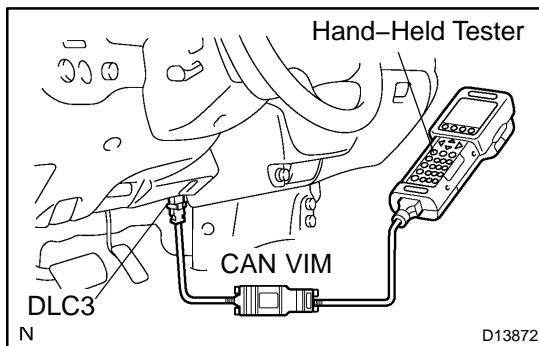

2. INSPECT ENGINE IDLE SPEED

- (a) When using a hand-held tester.
 - (1) Connect a hand-held tester to the Controller Area Network Vehicle Interface Module (CAN VIM). Then connect the CAN VIM to the Data Link Connector 3 (DLC3).
 - (2) Please refer to the hand-held tester operator's manual for further details.
 - (3) Race the engine speed at 2,500 rpm for approx. 90 seconds.
 - (4) Check the idle speed.

Idle speed: 700 ± 50 rpm

(Transmission in neutral)

If the idle speed is not as specified, check the air intake system.

- (5) Disconnect the hand-held tester and CAN VIM from the DLC3.

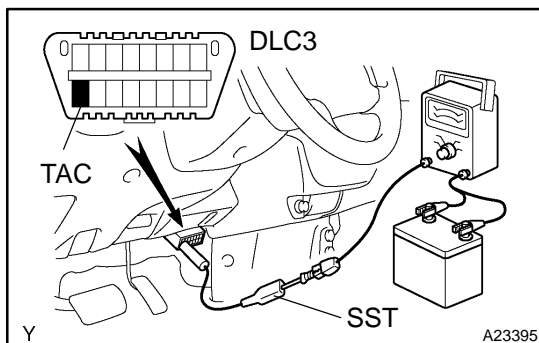

- (b) When not using a hand-held tester.

- (1) Using SST, connect the tachometer probe to terminal TAC of the DLC3.

SST 09843-18030

- (2) Race the engine at 2,500 rpm for approx. 90 seconds.

- (3) Check the idle speed.

Idle speed: 700 ± 50 rpm

(Transmission in neutral)

If the idle speed is not as specified, check the air intake system.

- (4) Disconnect the tachometer from the DLC3.